



# FACTORY ASSOCIATION QC

USER MANUAL



ANDROID APK

## TABLE OF CONTENTS

CHANGELOG .....	3
PURPOSE .....	4
SCOPE.....	4
DEFINITION(S) AND ABBREVIATION(S).....	4
INTRODUCTION .....	5
INSTALLATION OF FACTORY QC PHONE APPLICATION (VERSION 1.X).....	6
LOGS .....	11
LIST OF ERRORS, ALERTS, AND OK MESSAGES .....	14
APPLICATION VERSION LOG .....	16
MINIMUM REQUIREMENTS FOR THE PHONES .....	17
SUPPORTED PHONES.....	17

CONFIDENTIAL

## CHANGELOG

VERSION	DATE	AUTHOR(S)	DESCRIPTION OF MODIFICATIONS
1.0	19.07.2018	Dimiter Kyurkchiev	Initial Version
1.22	01.04.2021	Akash Panchal	Updated Application Changelog

CONFIDENTIAL

## PURPOSE

---

- Check the associations Status between coolers and smart devices.

## SCOPE

---

- Useful for Factory associations QC.

## DEFINITION(S) AND ABBREVIATION(S)

---

NAME	ABBREVIATION
BLE	Bluetooth Low Energy
FFA	Sollatek FFA Controller
FFX	Sollatek FFX Smart Device
JEA	Sollatek JEA Controller

## INTRODUCTION

### Application will:

- Check the associations Status between coolers and smart devices.

CONFIDENTIAL

## INSTALLATION OF FACTORY QC PHONE APPLICATION (VERSION 1.X)

1. Install APK received from a link in android phone.  
<https://apps.ebest-iot.com/oemfactory/>
2. Click on the **FACTORY QC ASSOCIATION** application icon. It will launch the application.  
**Note:** Before the launching of the Application, please ensure that Bluetooth & Internet are enabled.

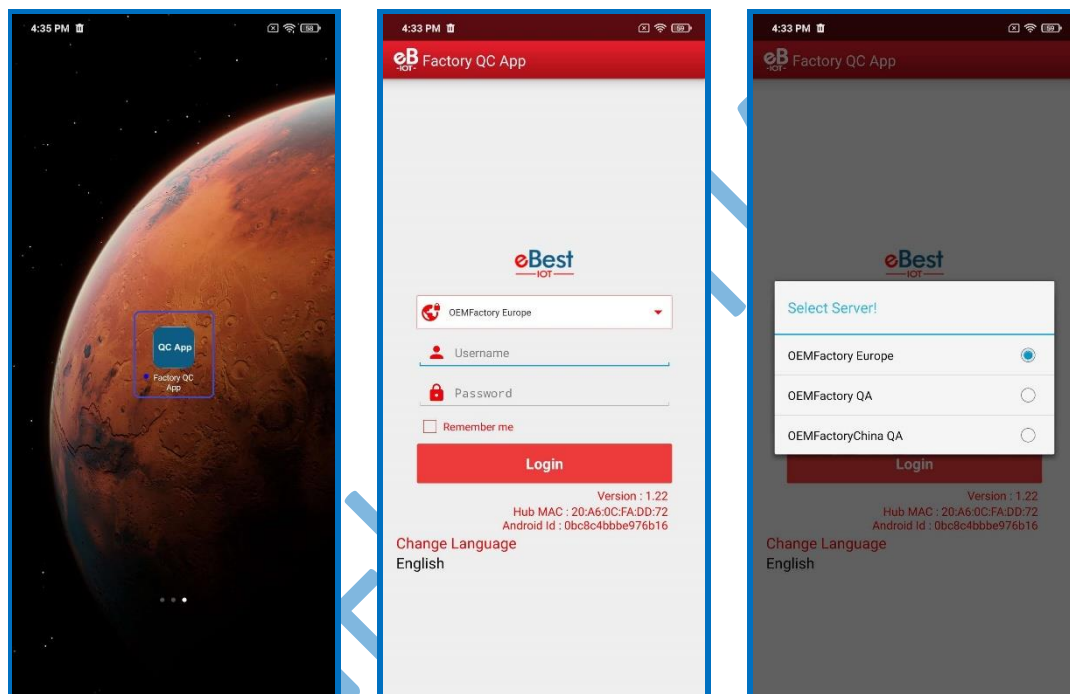

- Default **OEM Factory Europe** Server shows, depending on the Client and Factory user should choose a different option,
  - For CCH and CCEP the user can use the **OEM Factory Europe** server.
- If a user is logging for a first-time Username (User ID) and Password should be entered, and Language should be chosen. The username and password are case-sensitive. Also, users can remember that username and password by **Remember Me** Option.
- To change the language, tap on **Change Language** and use can choose the language. Currently, there is English language support available.
- Depending on the Android Version user may get several different prompts to confirm access to the camera, Bluetooth (location services), Storage, etc.
  - The user should Allow all requested for the application to work properly.

- If the user gets a prompt asking to **Ignore Battery Optimizations** confirm with **YES**.

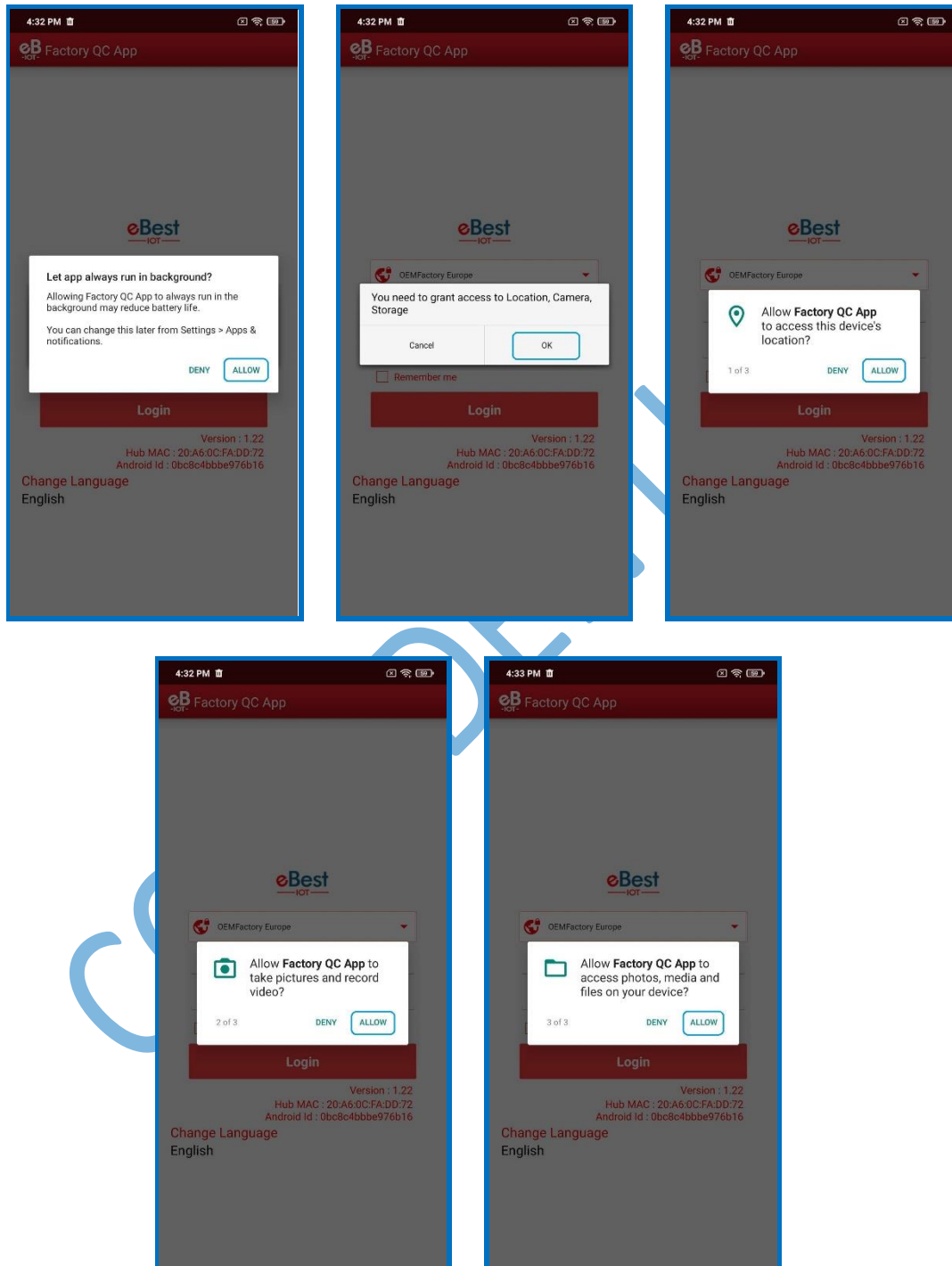

- Provide valid credentials and tap on the Login button, please be advised that the application will need some time to download data from the cloud.

**Note:** Internet connectivity is required during login otherwise login will fail and the application will not work

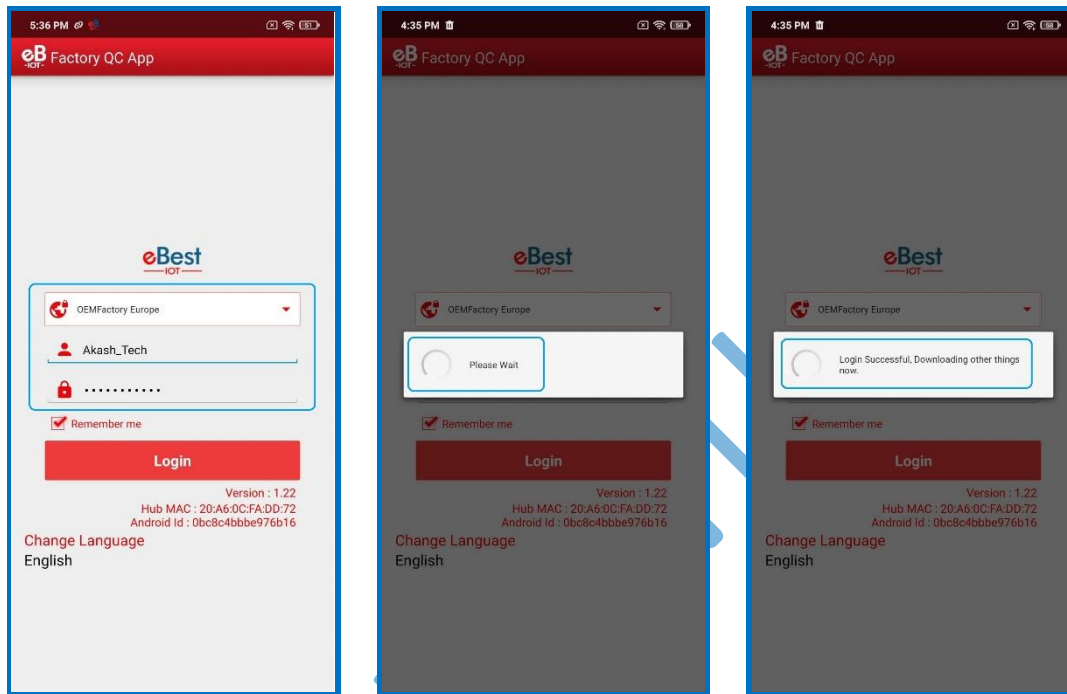

3. After done successful login, the following screen will be shown. Please choose the **Client/Bottler** from the List.

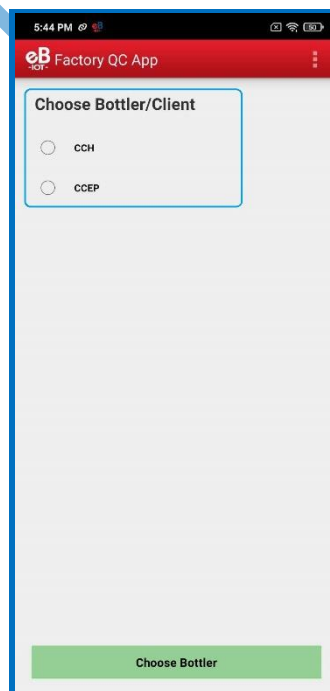



4. Tap on **SCAN BARCODE** and scan the barcode of the cooler. Cooler Serial Number could also be entered manually by tapping on **ENTER MANUALLY BARCODE**.

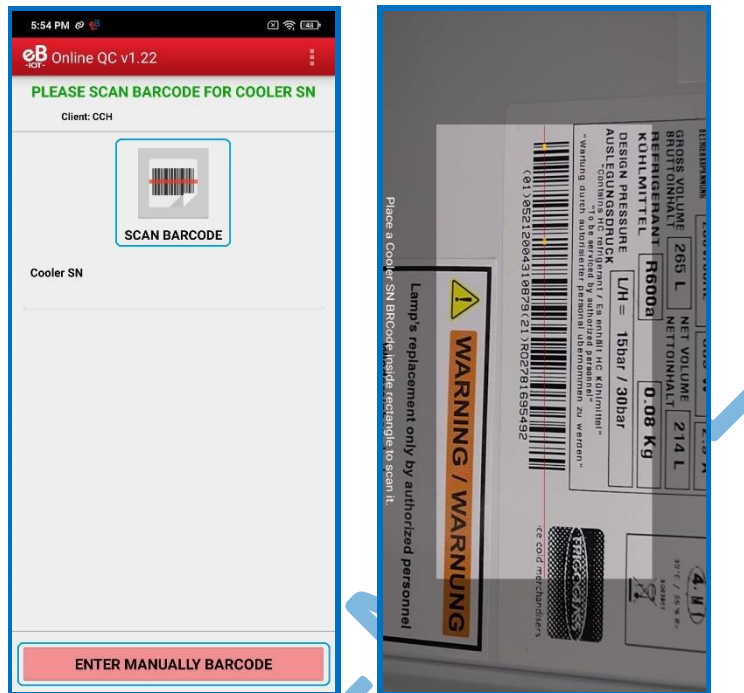

5. After the barcode of the cooler is successfully scanned open and close the door of the cooler to wake up the SmartTag and tap again on **SCAN BARCODE** for Smart Device Serial and scan the barcode of the SmartTag. Smart Device Serial Number could also be entered manually by tapping on **ENTER MANUALLY BARCODE**.

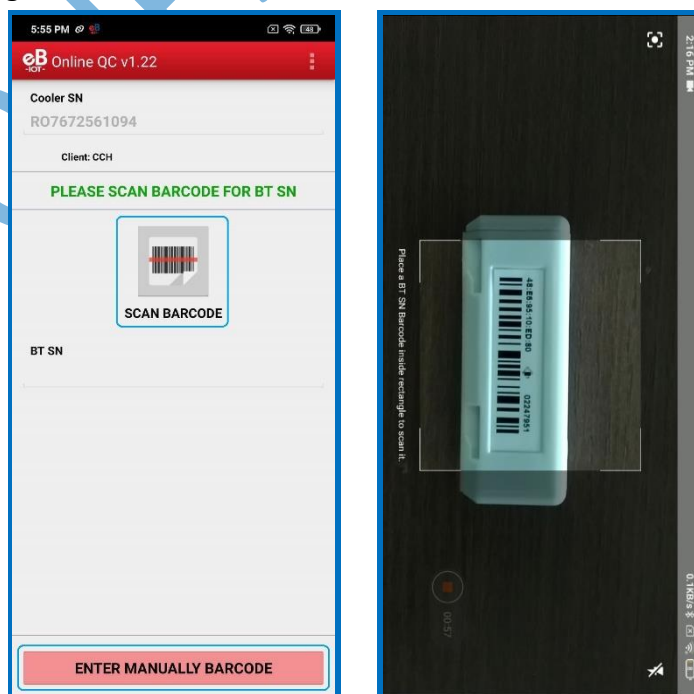

6. After the Smart Device Serial Number is successfully scanned the application will check the association in the eBest IoT System. The following message will be shown if the association between the scanned cooler and Smart Device are in the eBest IoT System.

If there is a problem with the association, an Error message will be shown. All the possible Errors and the reasons for them could be seen in the [LIST OF ERRORS, ALERTS, AND OK MESSAGES](#).

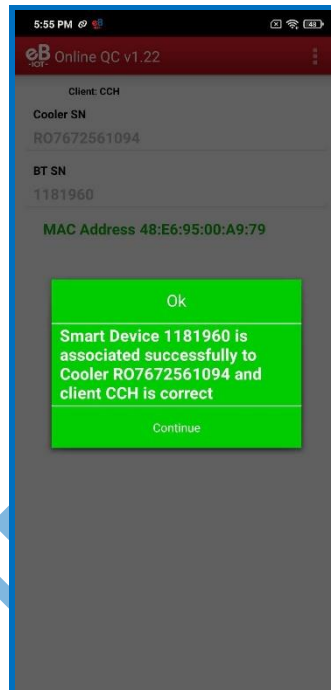

## LOGS

1. **QC DETAILS** – To Showing all the Cooler, Smart Device checks done and the results from those checks. If View is tapped, details are shown.

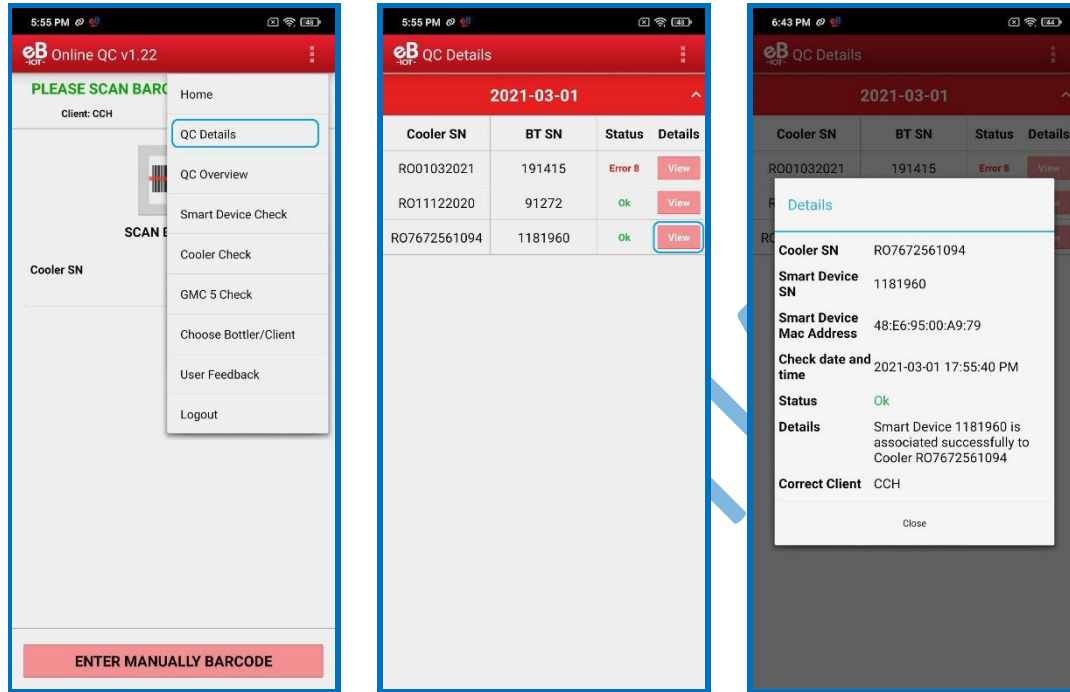

2. **QC OVERVIEW** – To Showing an Overview of the Cooler, Smart Device check Association.

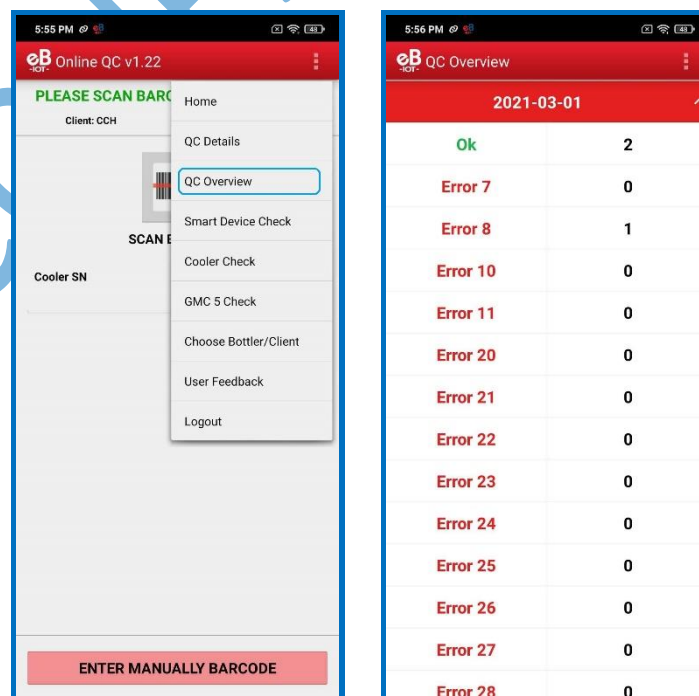

**3. SMART DEVICE CHECK – To Check a Smart Device without scanning a Cooler.**

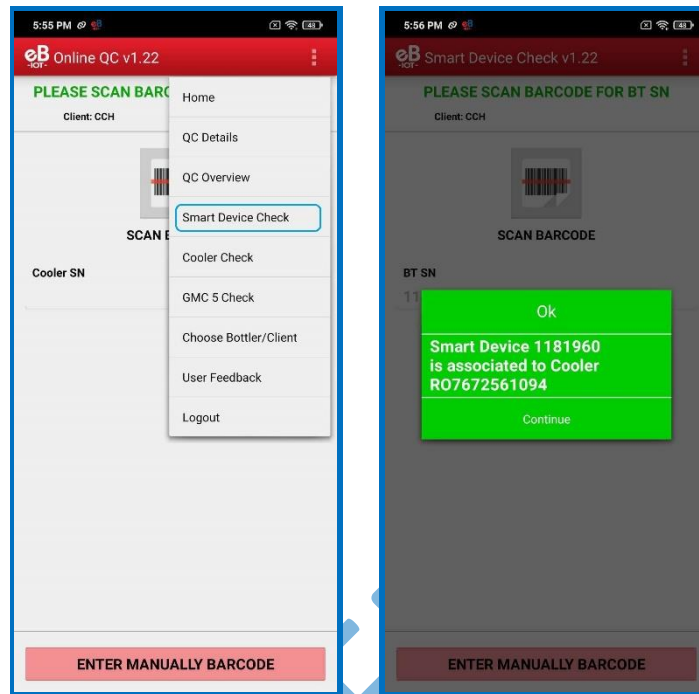

**4. COOLER CHECK – Check a Cooler without scanning a Smart Device.**

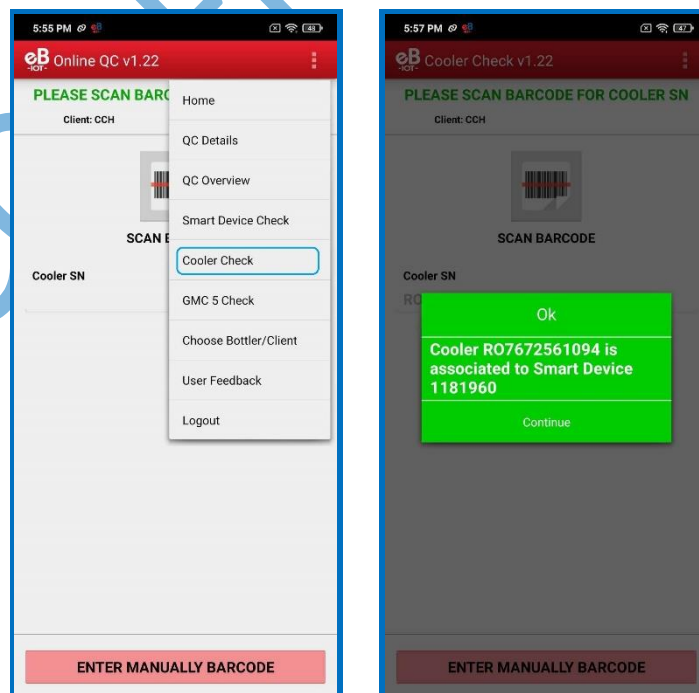

5. **GMC5 CHECK** – To Check a GMC5 Smart Device without scanning a Cooler.

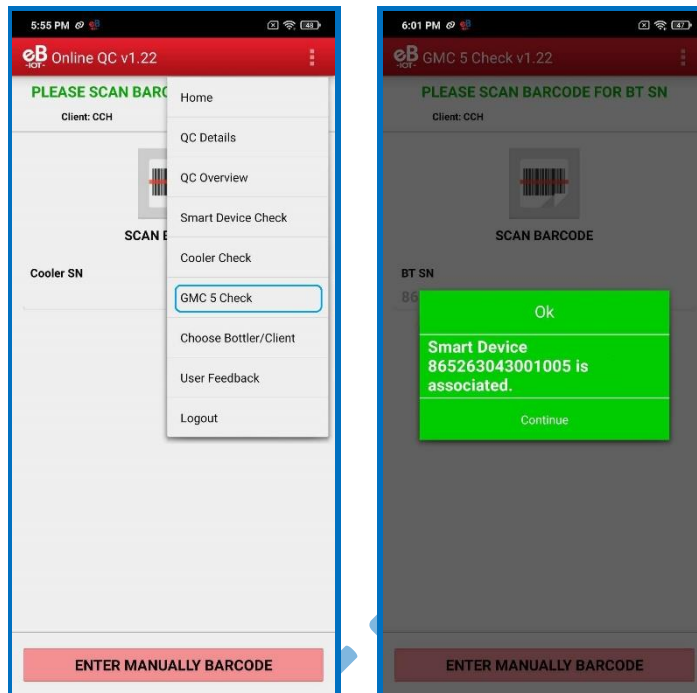

CONFIDENTIAL

## LIST OF ERRORS, ALERTS, AND OK MESSAGES

DETAILED MESSAGE	SHORT MESSAGE	USER STORY
Smart Device <SD SN> is associated successfully to Cooler <COOLER SN> and <CLIENT ID> is correct	OK	The user scans the SD SN and Cooler SN, the scanned SD, and Cooler are associated successfully.
Please check your internet connection and try again	ERROR 01	No Internet
Cannot connect to server, please try again	ERROR 02	No Internet or server not available
Smart Device <SD SN> and Cooler <COOLER SN> are not associated	ERROR 07	The user scans the SD SN and Cooler SN, the scanned SD is not associated, the scanned Cooler is not associated.
Smart Device <SD SN> is not associated and Cooler <COOLER SN> is not in the Portal	ERROR 08	The user scans the SD SN and Cooler SN, the scanned SD is not associated, the scanned Cooler is not in the Portal.
Smart Device <SD SN> is not in the portal and Cooler <COOLER SN> is not associated	ERROR 10	The user scans the SD SN and Cooler SN, the scanned SD is not in the Portal, the scanned Cooler is not associated.
Smart Device <SD SN> and Cooler <COOLER SN> are not in the Portal	ERROR 11	The user scans the SD SN and Cooler SN, the scanned SD is not in the Portal, the scanned Cooler is not in the Portal.
Smart Device <SD SN> is associated successfully to Cooler <COOLER SN> and <CLIENT ID> is incorrect	ERROR 20	The user scans the SD SN and Cooler SN, the scanned SD and Cooler are associated successfully, but the client is incorrect.
Smart Device <SD SN> is associated to <COOLER SN> and Cooler <COOLER SN> associated to Smart Device <SD SN> and the <CLIENT ID> is incorrect	ERROR 21	The user scans the SD SN and Cooler SN, the scanned SD is associated with a different Cooler, and the client selected is incorrect, than the one scanned. The scanned Cooler is also associated with a different SD than the one scanned.
Smart Device <SD SN> is associated to <COOLER SN> and Cooler <COOLER SN> associated to Smart Device <SD SN> and the <CLIENT ID> is correct	ERROR 22	The user scans the SD SN and Cooler SN, the scanned SD is associated to a different Cooler, and the client selected is correct, than the one scanned. The scanned Cooler is also associated with a different SD than the one scanned.
Smart Device <SD SN> is associated to <COOLER SN> and Cooler <COOLER SN> is not associated and the <CLIENT ID> is correct	ERROR 23	The user scans the SD SN and Cooler SN, the scanned SD is associated with a different Cooler than the one scanned, the scanned Cooler is not associated, but the client is correct.
Smart Device <SD SN> is associated to <COOLER SN> and Cooler <COOLER SN> is not associated and <CLIENT ID> is incorrect	ERROR 24	The user scans the SD SN and Cooler SN, the scanned SD is associated to a different Cooler than the one scanned, the scanned Cooler is not associated and the client is incorrect.

Smart Device <SD SN> is associated to <COOLER SN> and Cooler <COOLER SN> is not in the Portal and the <CLIENT ID> is correct	<b>ERROR 25</b>	The user scans the SD SN and Cooler SN, the scanned SD is associated with a different Cooler than the one scanned, the scanned Cooler does not exist in the Portal, but the client is correct.
Smart Device <SD SN> is associated with <COOLER SN> and Cooler <COOLER SN> is not in the Portal and the <CLIENT ID> is incorrect	<b>ERROR 26</b>	The user scans the SD SN and Cooler SN, the scanned SD is associated with a different Cooler than the one scanned, the scanned Cooler does not exist in the Portal, but the client is incorrect.
Smart Device <SD SN> is not associated and Cooler <COOLER SN> is associated to Smart Device <SD SN> and the <CLIENT ID> is correct	<b>ERROR 27</b>	The user scans the SD SN and Cooler SN, the scanned SD is not associated, the scanned Cooler is associated to a different SD than the scanned, but the client is correct.
Smart Device <SD SN> is not associated and Cooler <COOLER SN> is associated to Smart Device <SD SN> and the <CLIENT ID> is incorrect	<b>ERROR 28</b>	The user scans the SD SN and Cooler SN, the scanned SD is not associated, the scanned Cooler is associated to a different SD than the scanned, but the client is incorrect.
Smart Device <SD SN> is not in the Portal and Cooler <COOLER SN> is associated to Smart Device <SD SN> and the <CLIENT ID> is correct	<b>ERROR 29</b>	The user scans the SD SN and Cooler SN, the scanned SD is not in the Portal, the scanned Cooler is associated with a different SD than the one scanned and the client is correct.
Smart Device <SD SN> is not in the Portal and Cooler <COOLER SN> is associated to Smart Device <SD SN> and the <CLIENT ID> is incorrect	<b>ERROR 30</b>	The user scans the SD SN and Cooler SN, the scanned SD is not in the Portal, the scanned Cooler is associated with a different SD than the one scanned, but the client is not correct.
<b>SMART DEVICE CHECK</b>		
Smart Device <SD SN> is associated to Cooler <COOLER SN>	<b>OK</b>	The user scans the SD SN, the scanned SD is associated with Cooler SN.
Smart Device <SD SN> is not associated	<b>ERROR 12</b>	The user scans the SD SN, the scanned SD is not associated.
Smart Device <SD SN> is not in the Portal	<b>ERROR 13</b>	The user scans the SD SN, the scanned SD is not in the Portal
<b>COOLER CHECK</b>		
Cooler <COOLER SN> is associated to Smart Device <SD SN>	<b>OK</b>	The user scans the Cooler SN, the scanned Cooler is associated with SD SN.
Cooler <COOLER SN> is not associated	<b>ERROR 14</b>	The user scans the Cooler SN, the scanned Cooler is not associated.
Cooler <COOLER SN> is not in the Portal	<b>ERROR 15</b>	The user scans the Cooler SN, the scanned Cooler is not in the Portal

## APPLICATION VERSION LOG

VERSION	DATE	CHANGES
1.22	18.01.2021	Resolved Issue in GMC5 Check menu
1.21	23.12.2020	Login page show Gateway HUB and Android id Details. App Info get Gateway HUB from a single method An issue in Error Message
1.20	14.09.2020	Add support for GMC5 Smart device
1.19	20.03.2020	Changes some error messages for QC app
1.18	27.01.2020	Add support for UGUR Cooler Manufacturer Application Getting Stuck on Cooler Serial Screen
1.17	20.01.2020	Implemented the new error messages with client id
1.16	25.04.2019	QC and Association App URL change
1.15	10.04.2019	Added support for OEM Cloud.
1.14	20.02.2019	Introduce Factory Selection screen in the QC App
1.13	15.01.2019	Added support for the IN barcode in Cooler Serial Number scanning
1.12	08.01.2019	Bugfender SDK 1.1 Integration in Quality Control App Update barcode scanning implementation and library
1.11	-	Changed Association Check URL from InfoV2 to infoV2
1.10	-	Changed error code for Smart Device check and Cooler Check
1.9	-	Added support for Localization
1.8	-	Changed default strings for no internet connection and when the server is not responding
1.7	-	Resolved error 1 was not generated when there was no internet Changed success message title from 'Success' to "OK"
1.6	-	Added individual check for Smart Device SN and Cooler SN
1.5	-	Added QC Details and Overview with proper error message structure
1.4	-	Disable Offline module
1.3	-	Remove Unassigned device List checking logic from Online QC
1.2	-	Application stay connected with the device even after the success/failure message is displayed and also displays a message for "Disconnected". The device disconnects with the app when we kill the application OR the device is auto disconnect after connection timeout. It is observed that the device is not getting connected within 2 minutes of scanning and display the message for retry, then the device is not connected in the extra trial. We can connect the device when we close the application and try again. Smart tag association removed and checked in online QC mode with another cooler SN, Showing Association OK even when the association has been removed.
1.1	-	Added QC module for checking association data from cloud-side
1.0	-	Added Frigoglass QC module and checking Cooler SN in BLE Device



## MINIMUM REQUIREMENTS FOR THE PHONES

COMPONENT	MINIMUM REQUIRED
OPERATING SYSTEM	Android 6.0 (Marshmallow)
OPERATING MEMORY (RAM)	2 GB to 4 GB or more
FREE STORAGE	2 GB
CAMERA	At least 5.0 MP with Autofocus
PROCESSOR (CPU)	A quad-core processor or faster
BLUETOOTH	BLE 4.1 and above

## SUPPORTED PHONES

- Alcatel Pixi 4
- Asus Zenfone Go (ZB500KL)
- Asus Zenfone Max Pro M1
- Google Pixel 3a
- One plus 3T (A3003)
- Samsung Galaxy A10
- Samsung Galaxy S5
- Samsung Galaxy S7
- Samsung's Galaxy Xcover 4 SM-G390F
- Xiaomi Redmi 4
- Xiaomi Redmi 6 Pro
- Xiaomi Redmi Note 4